



User Manual

ATEX Explosion-proof handlamp

- 1. Model and its meanings**
Explosion-proof handlamp AT-1280(Rechargeable, LED light source)
Explosion-proof handlamp AT-1080(Dry-Battery Type, LED light source)

2. Explosion-proof Standard:

EC 60079-0:2007, IEC 60079-7:2006, IEC 60079-11:2006, IEC60079-31:2008, Applicable Directive 94/9/EC

3. Main specifications and technical parameters

Code	AT-1280	AT-1080
EX Mark & ATEX Mark	II 2G Ex e ib IIC T4 Gb II 2D Ex t IIIC T130°C Db IP66	II 2G Ex e ib IIC T4 Gb II 2D Ex t IIIC T130°C Db IP66
Power source	4V/5AH sealed lead acid battery	4/1.5V primary cells
Ingress Protection	IP66	IP66
Voltage(V)	4V	6V
Current(mA)	220	220

Matsuda, AT-1280 explosion-proof hand lamp meets all relevant provisions of the 94/9/EC Explosive Atmospheres (ATEX Equipment) Directive. It is a self-contained rechargeable safety hand lamp, with 11 pcs 3.0-3.2V 180mA high intensity LED, powered by a small

1

Valve-regulated lead-acid battery pack with integral intrinsic safety protection. AT-1280 body is moulded in high impact strength anti-static plastic. The scratch and impact resistant lens is made from toughened glass. The hand lamp is supplied with a convenient removable shoulder strap.

Matsuda, AT-1080 is primary cell (non- rechargeable) powered safety hand lamp , has been 'CE' marked in compliance with the 94/9/EC Explosive Atmospheres' (ATEX)Directive, the light source is composed by 11 pcs 3.0-3.2V 180mA high intensity LED; The lamp is constructed from a new, exceptionally robust and highly durable thermoplastic material , the material is anti-static, preventing the build up of potentially dangerous electrostatic charges. A toughened, scratch resistant glass lens with high quality rubber seal, to ensure that the lamp is protected from ingress of dusts and liquids . The lamp is supplied complete with a convenient removable shoulder strap.

The ATEX series hand lamps are suitable for Zone 1 and Zone 2 in Class 2; Zone 21 and Zone 22 environment, IIA, IIB, IIC, class, temperature group T1 ~ T4 explosive gas atmospheres, the maximum surface temperature is 130 degrees.

Ingress protection is IP66, to ensure the effective protection of this product in the most dust and wet conditions can still be used normally. Please note that this product can not be soaked in water.

This product meets the relevant standards of the European Union CE, and marked with the CE mark.

4. Use & Maintenance

While users to purchase the electrical products used in explosion-proof environment, they should advisory to the professionals.

2

Before using the product, the user must check the product, whether is damage; such as the product is defective, you must stop using the product.

⚠ To open the product in explosive dust and gas in hazardous environments is prohibited .

⚠ Before using the Matsuda AT-1280 explosion-proof hand lamp, please charging the product first . Charging of the product in explosive gas and dust environment is strictly prohibited;

⚠ Before using the Matsuda, AT-1080 explosion-proof hand lamp, please install four dry-batteries. To install or replace the battery in explosive gas and dust environment is strictly prohibited (Figure E-3) ;

4.1 When you need to open the torch head (AT-1280), make sure the magnetic switch in the closed position, and then use the hex wrench clockwise rotation the interlocking screws, to let the interlocking screw head into the groove of magnetic switch. At this time the magnetic switch is controlled by the interlocking screw, the switch will not be able to move, ensure the safe use and maintenance. when the torch head is mounted back to the torch. Use the hex wrench counterclockwise rotation the interlocking screws, push the screw head out of the magnetic switch, the product can use normally (Figure D-3) ;

4.2 Magnetic switch operation: the control switch is below the handle, swing around in the direction to control the light (Figure D-1` E-1,) .

4.3 Magnetic switch replacement: The company will provide a magnetic switch components for users to purchase, please contact your local dealer;

3

Before using the product, the user must check the product, whether is damage; such as the product is defective, you must stop using the product.

⚠ To open the product in explosive dust and gas in hazardous environments is prohibited .

⚠ Before using the Matsuda AT-1280 explosion-proof hand lamp, please charging the product first . Charging of the product in explosive gas and dust environment is strictly prohibited;

⚠ Before using the Matsuda, AT-1080 explosion-proof hand lamp, please install four dry-batteries. To install or replace the battery in explosive gas and dust environment is strictly prohibited (Figure E-3) ;

4.1 When you need to open the torch head (AT-1280), make sure the magnetic switch in the closed position, and then use the hex wrench clockwise rotation the interlocking screws, to let the interlocking screw head into the groove of magnetic switch. At this time the magnetic switch is controlled by the interlocking screw, the switch will not be able to move, ensure the safe use and maintenance. when the torch head is mounted back to the torch. Use the hex wrench counterclockwise rotation the interlocking screws, push the screw head out of the magnetic switch, the product can use normally (Figure D-3) ;

4.2 Magnetic switch operation: the control switch is below the handle, swing around in the direction to control the light (Figure D-1` E-1,) .

4.3 Magnetic switch replacement: The company will provide a magnetic switch components for users to purchase, please contact your local dealer;

3

Before using the product, the user must check the product, whether is damage; such as the product is defective, you must stop using the product.

⚠ To open the product in explosive dust and gas in hazardous environments is prohibited .

⚠ Before using the Matsuda AT-1280 explosion-proof hand lamp, please charging the product first . Charging of the product in explosive gas and dust environment is strictly prohibited;

⚠ Before using the Matsuda, AT-1080 explosion-proof hand lamp, please install four dry-batteries. To install or replace the battery in explosive gas and dust environment is strictly prohibited (Figure E-3) ;

4.1 When you need to open the torch head (AT-1280), make sure the magnetic switch in the closed position, and then use the hex wrench clockwise rotation the interlocking screws, to let the interlocking screw head into the groove of magnetic switch. At this time the magnetic switch is controlled by the interlocking screw, the switch will not be able to move, ensure the safe use and maintenance. when the torch head is mounted back to the torch. Use the hex wrench counterclockwise rotation the interlocking screws, push the screw head out of the magnetic switch, the product can use normally (Figure D-3) ;

4.2 Magnetic switch operation: the control switch is below the handle, swing around in the direction to control the light (Figure D-1` E-1,) .

4.3 Magnetic switch replacement: The company will provide a magnetic switch components for users to purchase, please contact your local dealer;

3

Before using the product, the user must check the product, whether is damage; such as the product is defective, you must stop using the product.

⚠ To open the product in explosive dust and gas in hazardous environments is prohibited .

⚠ Before using the Matsuda AT-1280 explosion-proof hand lamp, please charging the product first . Charging of the product in explosive gas and dust environment is strictly prohibited;

⚠ Before using the Matsuda, AT-1080 explosion-proof hand lamp, please install four dry-batteries. To install or replace the battery in explosive gas and dust environment is strictly prohibited (Figure E-3) ;

4.1 When you need to open the torch head (AT-1280), make sure the magnetic switch in the closed position, and then use the hex wrench clockwise rotation the interlocking screws, to let the interlocking screw head into the groove of magnetic switch. At this time the magnetic switch is controlled by the interlocking screw, the switch will not be able to move, ensure the safe use and maintenance. when the torch head is mounted back to the torch. Use the hex wrench counterclockwise rotation the interlocking screws, push the screw head out of the magnetic switch, the product can use normally (Figure D-3) ;

4.2 Magnetic switch operation: the control switch is below the handle, swing around in the direction to control the light (Figure D-1` E-1,) .

4.3 Magnetic switch replacement: The company will provide a magnetic switch components for users to purchase, please contact your local dealer;

3

Before using the product, the user must check the product, whether is damage; such as the product is defective, you must stop using the product.

⚠ To open the product in explosive dust and gas in hazardous environments is prohibited .

⚠ Before using the Matsuda AT-1280 explosion-proof hand lamp, please charging the product first . Charging of the product in explosive gas and dust environment is strictly prohibited;

⚠ Before using the Matsuda, AT-1080 explosion-proof hand lamp, please install four dry-batteries. To install or replace the battery in explosive gas and dust environment is strictly prohibited (Figure E-3) ;

4.1 When you need to open the torch head (AT-1280), make sure the magnetic switch in the closed position, and then use the hex wrench clockwise rotation the interlocking screws, to let the interlocking screw head into the groove of magnetic switch. At this time the magnetic switch is controlled by the interlocking screw, the switch will not be able to move, ensure the safe use and maintenance. when the torch head is mounted back to the torch. Use the hex wrench counterclockwise rotation the interlocking screws, push the screw head out of the magnetic switch, the product can use normally (Figure D-3) ;

4.2 Magnetic switch operation: the control switch is below the handle, swing around in the direction to control the light (Figure D-1` E-1,) .

4.3 Magnetic switch replacement: The company will provide a magnetic switch components for users to purchase, please contact your local dealer;

3

Before using the product, the user must check the product, whether is damage; such as the product is defective, you must stop using the product.

⚠ To open the product in explosive dust and gas in hazardous environments is prohibited .

⚠ Before using the Matsuda AT-1280 explosion-proof hand lamp, please charging the product first . Charging of the product in explosive gas and dust environment is strictly prohibited;

⚠ Before using the Matsuda, AT-1080 explosion-proof hand lamp, please install four dry-batteries. To install or replace the battery in explosive gas and dust environment is strictly prohibited (Figure E-3) ;

4.1 When you need to open the torch head (AT-1280), make sure the magnetic switch in the closed position, and then use the hex wrench clockwise rotation the interlocking screws, to let the interlocking screw head into the groove of magnetic switch. At this time the magnetic switch is controlled by the interlocking screw, the switch will not be able to move, ensure the safe use and maintenance. when the torch head is mounted back to the torch. Use the hex wrench counterclockwise rotation the interlocking screws, push the screw head out of the magnetic switch, the product can use normally (Figure D-3) ;

4.2 Magnetic switch operation: the control switch is below the handle, swing around in the direction to control the light (Figure D-1` E-1,) .

4.3 Magnetic switch replacement: The company will provide a magnetic switch components for users to purchase, please contact your local dealer;

3

Before using the product, the user must check the product, whether is damage; such as the product is defective, you must stop using the product.

⚠ To open the product in explosive dust and gas in hazardous environments is prohibited .

⚠ Before using the Matsuda AT-1280 explosion-proof hand lamp, please charging the product first . Charging of the product in explosive gas and dust environment is strictly prohibited;

⚠ Before using the Matsuda, AT-1080 explosion-proof hand lamp, please install four dry-batteries. To install or replace the battery in explosive gas and dust environment is strictly prohibited (Figure E-3) ;

4.1 When you need to open the torch head (AT-1280), make sure the magnetic switch in the closed position, and then use the hex wrench clockwise rotation the interlocking screws, to let the interlocking screw head into the groove of magnetic switch. At this time the magnetic switch is controlled by the interlocking screw, the switch will not be able to move, ensure the safe use and maintenance. when the torch head is mounted back to the torch. Use the hex wrench counterclockwise rotation the interlocking screws, push the screw head out of the magnetic switch, the product can use normally (Figure D-3) ;

4.2 Magnetic switch operation: the control switch is below the handle, swing around in the direction to control the light (Figure D-1` E-1,) .

4.3 Magnetic switch replacement: The company will provide a magnetic switch components for users to purchase, please contact your local dealer;

3

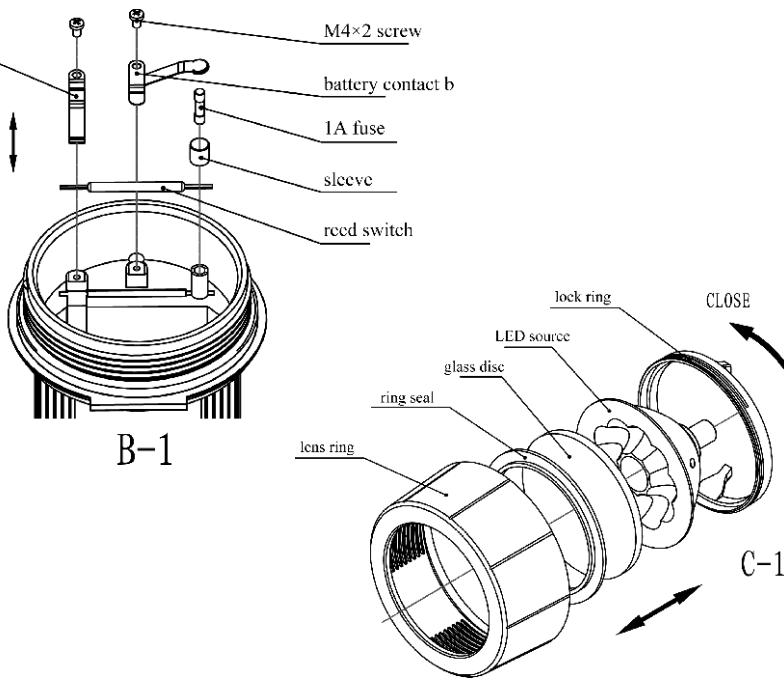

6

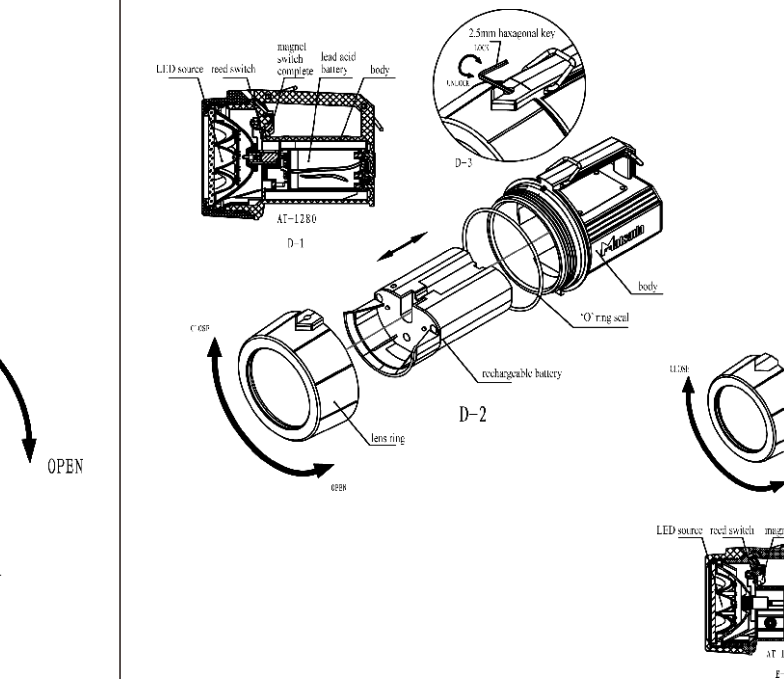

7

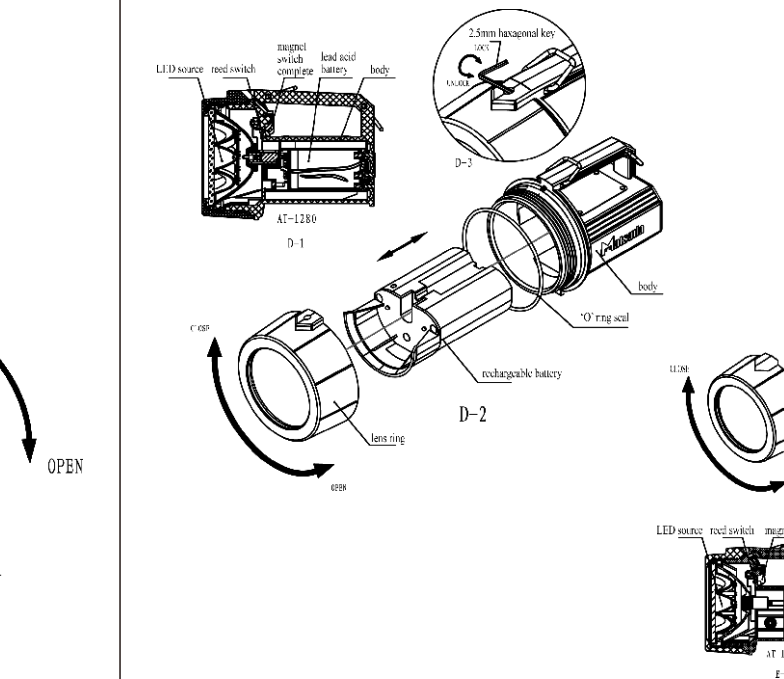

7

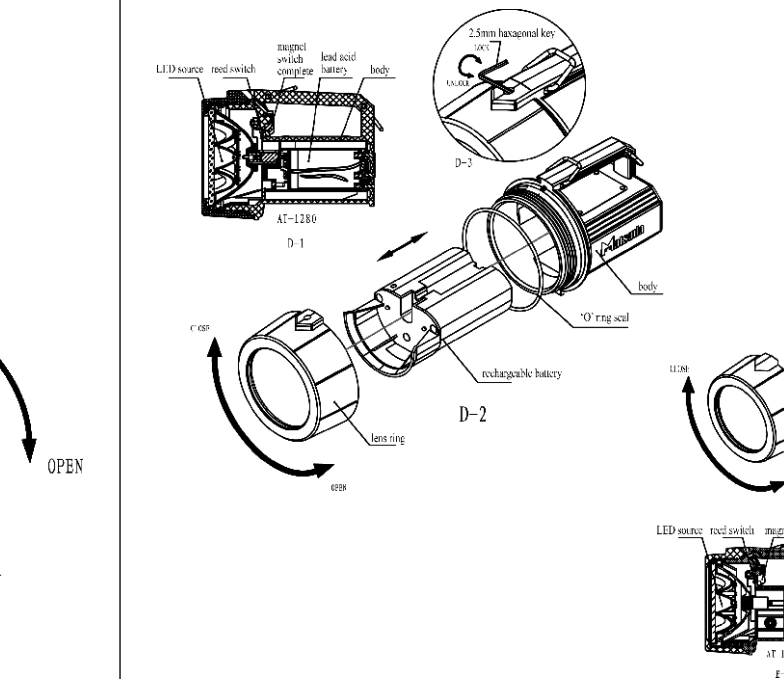

7

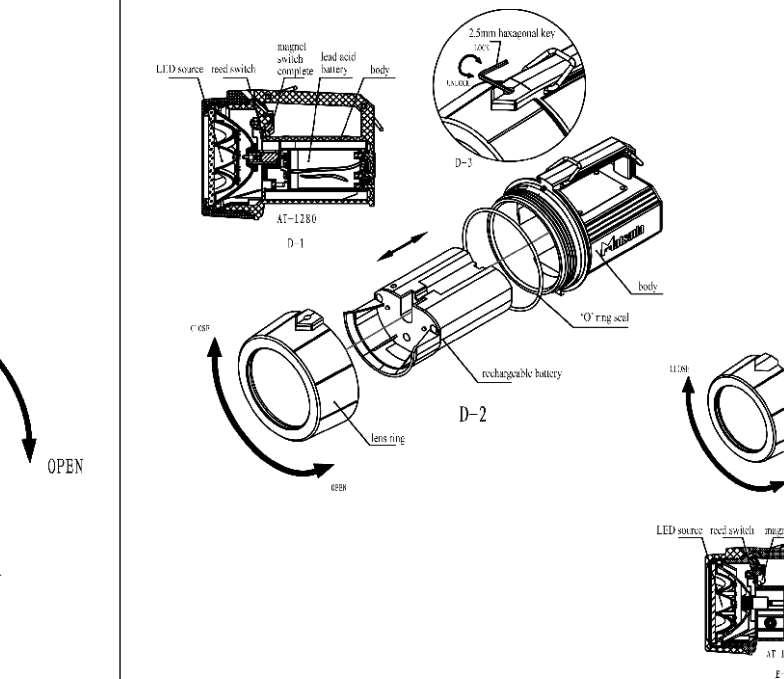

7